

MATCHLINE (SEE SHEET C-603)
MATCHLINE (SEE SHEET C-602)

| Label | Units | Avg | Max | Min | Avg/Min | Max/Min | FtSpctLr | FtSpctBt |
|-------------------------|-------|------|-----|-----|---------|---------|----------|----------|
| BUILDING 1 | Fc | 1.48 | 4.6 | 0.2 | 7.40 | 23.00 | 20 | 20 |
| BUILDING 1 & 2 ENTRANCE | Fc | 2.09 | 4.4 | 0.4 | 5.23 | 11.00 | | |
| BUILDING 2 | Fc | 1.46 | 4.7 | 0.3 | 4.87 | 15.67 | | |
| BUILDING 3 | Fc | 1.29 | 4.6 | 0.1 | 12.90 | 46.00 | | |
| BUILDING 4 | Fc | 1.48 | 4.3 | 0.2 | 7.40 | 21.50 | | |

| Symbol | Qty | Label | Total Lamp Lumens | LLF | Description | Lum. Watts |
|--------|-----|-------|-------------------|-------|---|------------|
| | 12 | A | N.A. | 0.950 | WLS-MIR-5W-LED-HO-50 27' POLE 3' BASE | 244 |
| | 53 | B | N.A. | 0.950 | WLS-MIR-FT-LED-HO-50 27' POLE 3' BASE | 241.3 |
| | 4 | C | N.A. | 0.950 | WLS-MIR-2-LED-HO-50 27' POLE 3' BASE | 241 |
| | 5 | D | N.A. | 0.950 | WLS-MIR-FT-LED-HO-50-IL 27' POLE 3' BASE | 241.3 |
| | 115 | E | N.A. | 0.950 | WLS-MIRW-FT-LED-08-50 16' MOUNTING HEIGHT | 76 |

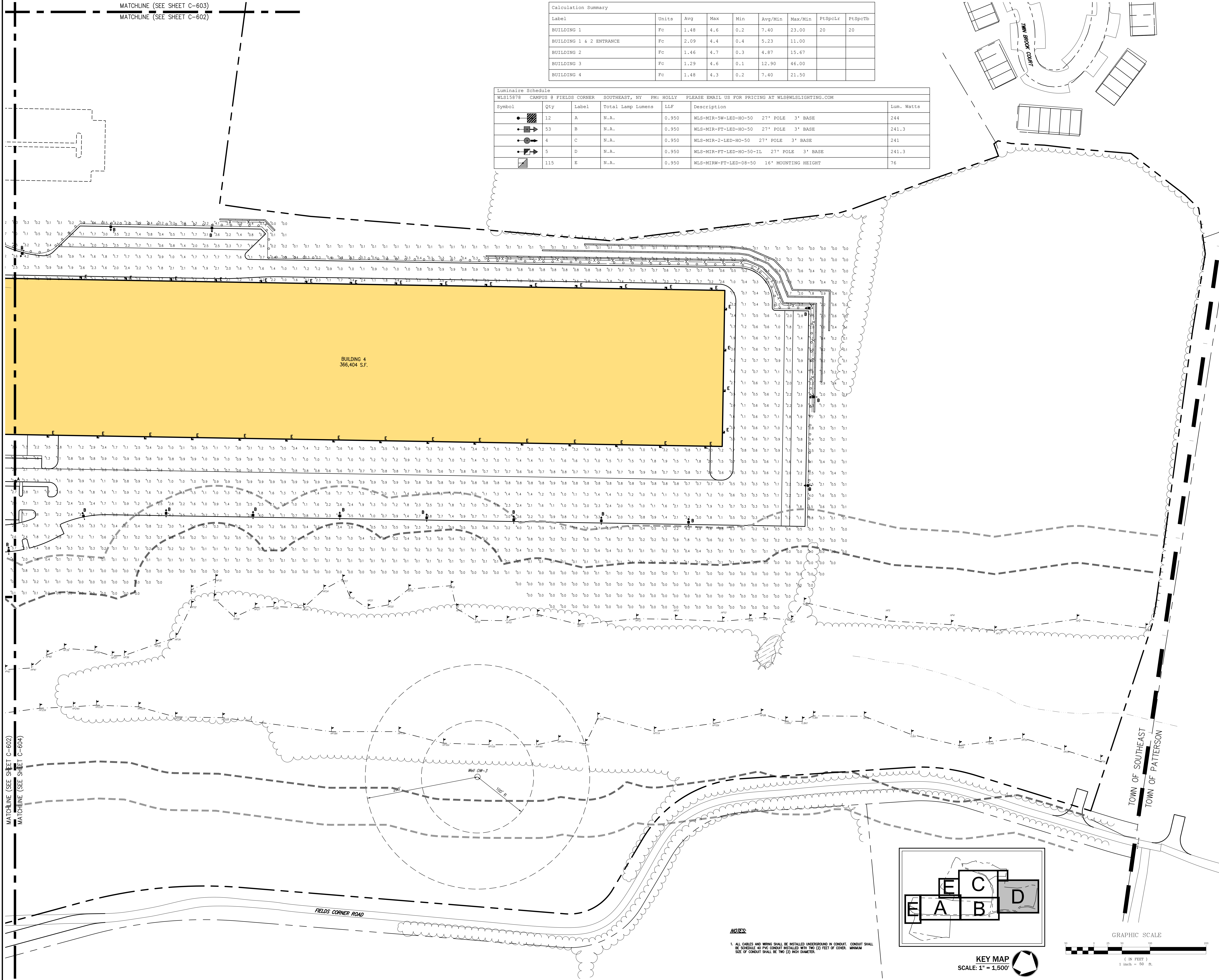

BUILDING 4
366,404 S.F.

MATCHLINE (SEE SHEET C-602)
MATCHLINE (SEE SHEET C-604)

NOT FOR CONSTRUCTION

NOTES:
1. ALL CABLES AND WIRING SHALL BE INSTALLED UNDERGROUND IN CONDUIT. CONDUIT SHALL BE SCHEDULE 40 PVC CONDUIT INSTALLED WITH TWO (2) FEET OF COVER. MINIMUM SIZE OF CONDUIT SHALL BE TWO (2) INCH DIAMETER.

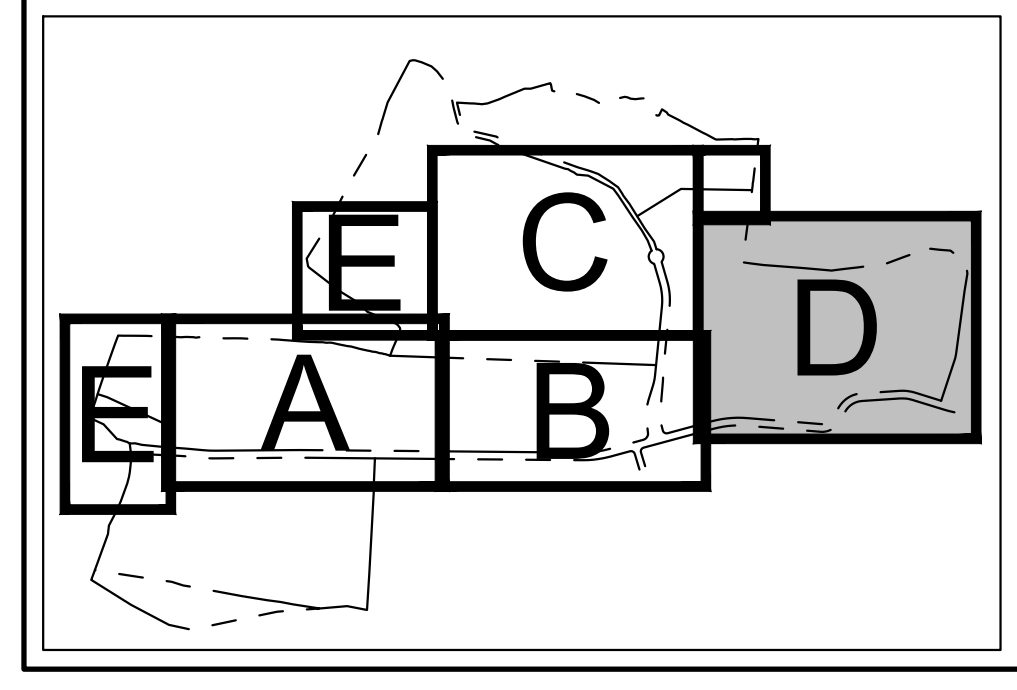

KEY MAP
SCALE: 1" = 1,500'

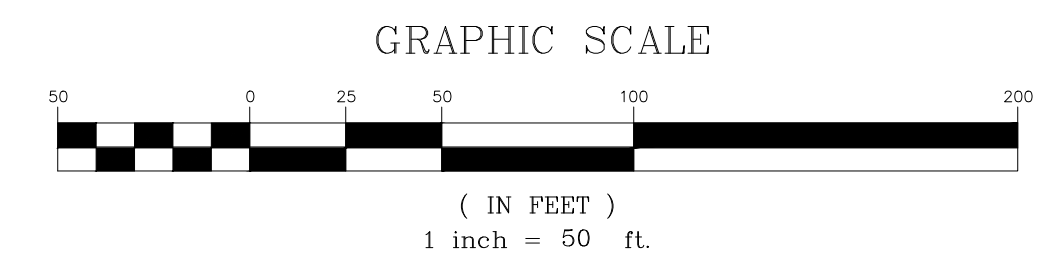

| No. | Revision | Date | By |
|-----|-----------------------------|------------|-----|
| 1 | ISSUE COMPLETION SUBMISSION | 05/17/2018 | KRM |

PUTNAM SEABURY PARTNERS, L.P.
287 KING STREET
CHAPPAQUA, NY 10514

JMC Planning, Engineering, Landscape Architecture & Land Surveying, LLC
John Meyer Consulting, Inc.
123 BEVERLY ROAD - HERRING, NY 13343
PHONE: 518.233.5535 - FAX: 518.272.4102
www.jmcplc.com

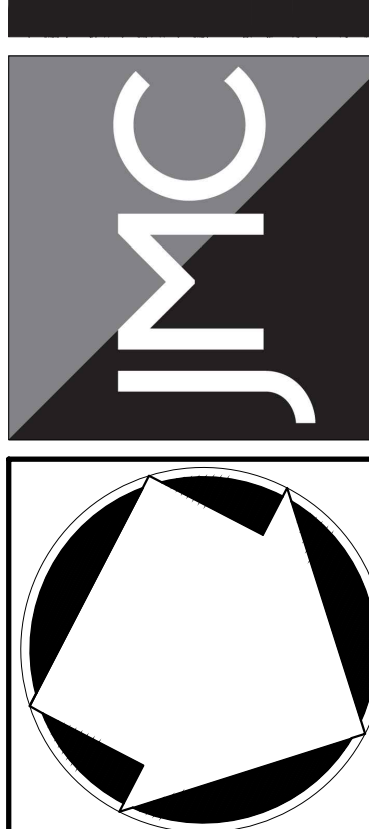

LIGHTING PLAN 'D'
NORTHEAST INTERSTATE LOGISTICS CENTER
TOWN OF SOUTHEAST, NEW YORK

ANY ALTERATION OF PLANS, SPECIFICATIONS, PLATS AND REPORTS BEARING THE SEAL OF A LICENSED PROFESSIONAL ENGINEER OR LICENSED LAND SURVEYOR IS A VIOLATION OF SECTION 7209 OF THE NEW YORK STATE EDUCATION LAW, EXCEPT AS PROVIDED FOR BY SECTION 7209 SUBSECTION 2.

| | |
|---------------------------|----------------|
| Drawn: KRM | Approved: R.P. |
| Scale: 1" = 50' | |
| Date: 11/06/2017 | |
| Project No: 14012 | |
| Client: LIGHTING PLAN 'D' | |
| C-604 | |