

Label	Units	Avg	Max	Min	Avg/Min	Max/Min	PtSpcLr	PtSpcTb
BUILDING 1	Fc	1.48	4.6	0.2	7.40	23.00	20	20
BUILDING 1 & 2 ENTRANCE	Fc	2.09	4.4	0.4	5.23	11.00		
BUILDING 2	Fc	1.46	4.7	0.3	4.87	15.67		
BUILDING 3	Fc	1.29	4.6	0.1	12.90	46.00		
BUILDING 4	Fc	1.48	4.3	0.2	7.40	21.50		

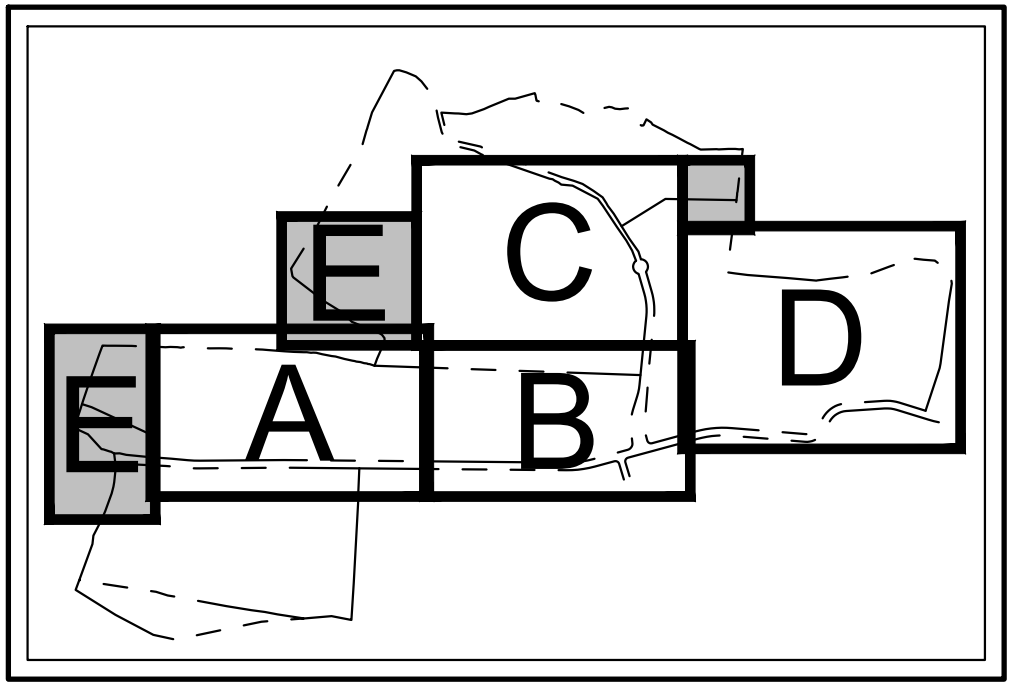

**NOTES**  
 1. ALL CABLES AND WIRING SHALL BE INSTALLED UNDERGROUND IN CONDUIT. CONDUIT SHALL BE SCHEDULE 40 PVC CONDUIT INSTALLED WITH TWO (2) FEET OF COVER. MINIMUM SIZE OF CONDUIT SHALL BE TWO (2) INCH DIAMETER.

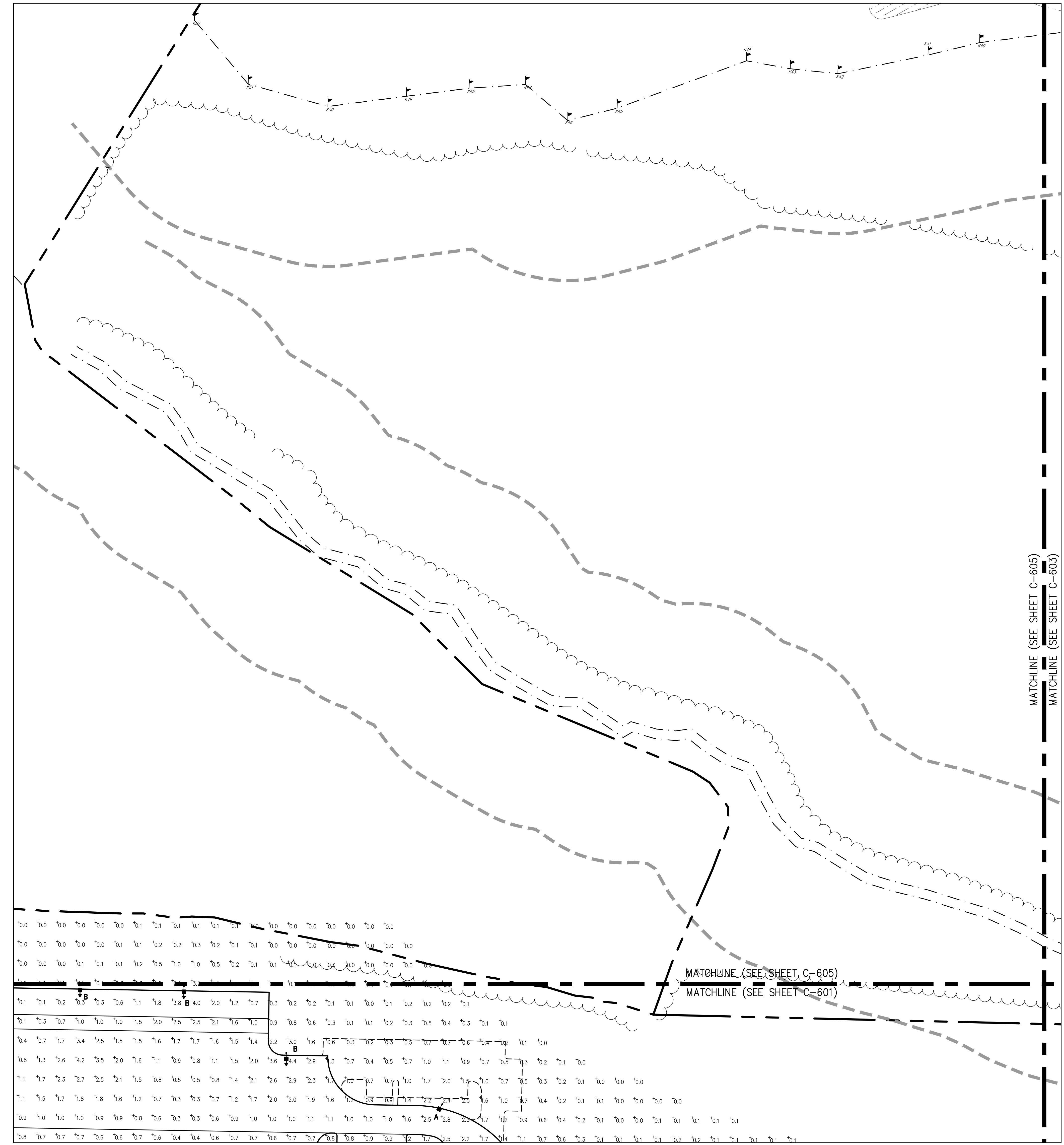
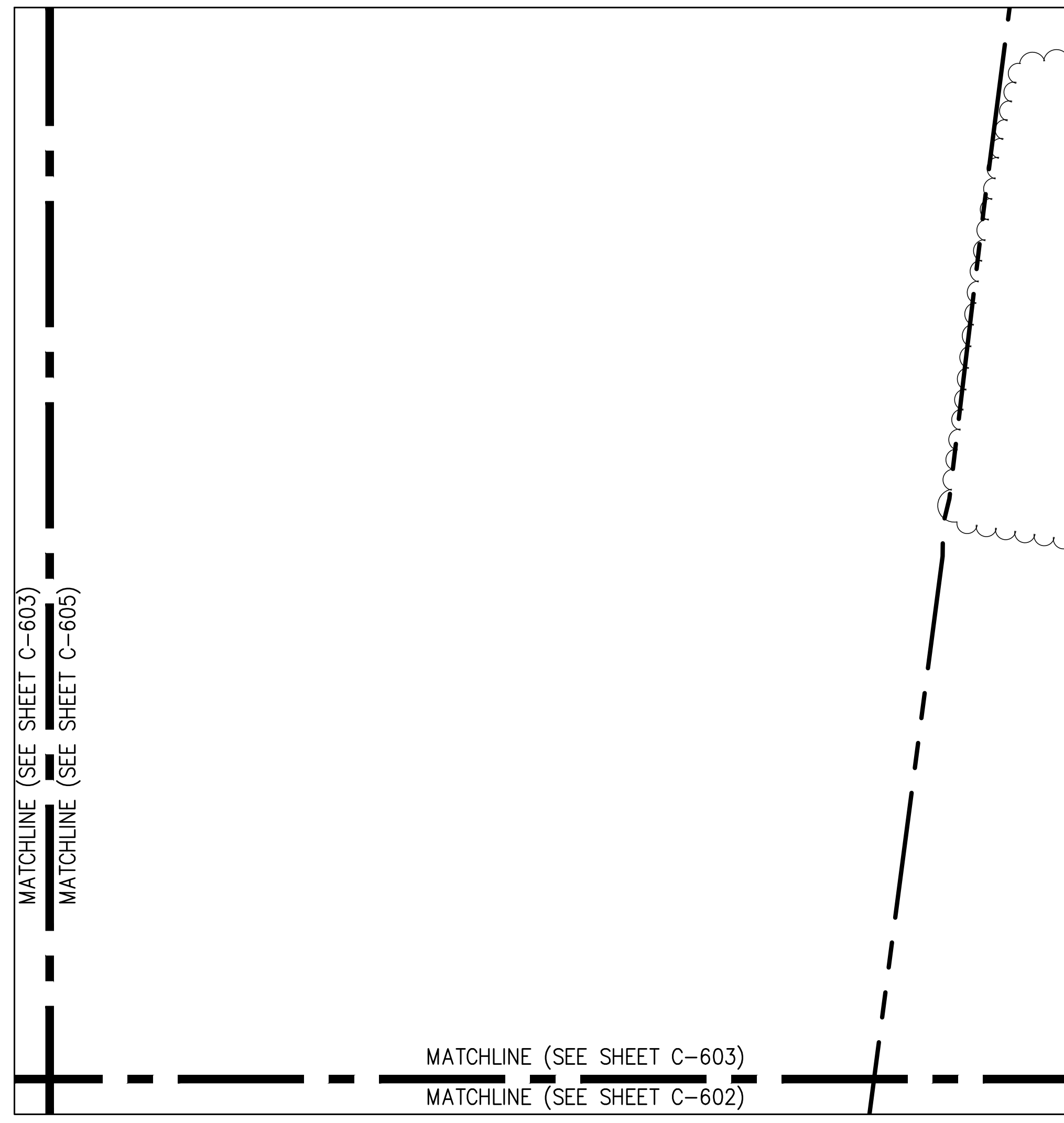

NOT FOR CONSTRUCTION

Symbol	Qty	Label	Total Lamp Lumens	LLF	Description	Lum. Watts
	12	A	N.A.	0.950	WLS-MIR-SW-LED-HO-50 27' POLE 3' BASE	244
	53	B	N.A.	0.950	WLS-MIR-FT-LED-HO-50 27' POLE 3' BASE	241.3
	4	C	N.A.	0.950	WLS-MIR-2-LED-HO-50 27' POLE 3' BASE	241
	5	D	N.A.	0.950	WLS-MIR-FT-LED-HO-50-IL 27' POLE 3' BASE	241.3
	115	E	N.A.	0.950	WLS-MIRW-FT-LED-08-50 16' MOUNTING HEIGHT	76

<p>APPLICANT/OWNER: <b>PUTNAM SEABURY PARTNERS, L.P.</b> 287 KING STREET CHAPPAQUA, NY 10514</p>	<p>DATE: 05/11/2018 BY: KRM</p> <p>REVISION: 1. EBS COMPLETNESS SUBMISSION</p>
<p>ANY ALTERATION OF PLANS, SPECIFICATIONS, PLATS AND REPORTS BEARING THE SEAL OF A LICENSED PROFESSIONAL ENGINEER OR LICENSED LAND SURVEYOR IS A VIOLATION OF SECTION 7209 OF THE NEW YORK STATE EDUCATION LAW, EXCEPT AS PROVIDED FOR BY SECTION 7209. SUBSECTION 2.</p>	
<p><b>JMC</b></p> <p><b>JOHN MEYER CONSULTING, INC.</b> 123 BEVERLY DR. - WESTBORO, MA 01581 PHONE: 978.335.5555 FAX: 978.335.2102 WWW.JMPCINC.COM</p>	
<p><b>LIGHTING PLAN 'E'</b> NORTHEAST INTERSTATE LOGISTICS CENTER TOWN OF SOUTHEAST, NEW YORK</p>	
<p>Drawn: KRM Approved: R.P. Scale: 1" = 50' Date: 11/06/2017 Project No: 14012 Client: LIGHTING ENGINEERING <b>C-605</b></p>	