

NOTES:

- EXISTING CONDITIONS DEPICTED ON THIS PLAN HAVE BEEN TAKEN FROM SURVEYS PREPARED BY BADEY & WATSON, SURVEYING AND ENGINEERING, P.C.
- GEOTECHNICAL BORING/TEST PIT LOCATIONS DEPICTED ON THIS PLAN WERE TAKEN FROM THE GEOTECHNICAL REPORT ENTITLED, "PRELIMINARY SUBSURFACE INVESTIGATION", DATED 10/07/1991, PREPARED BY SEB CONSULTING ENGINEERS.
- PIPE FOR STORM DRAINS IDENTIFIED AS HOPE HEREON SHALL BE HIGH DENSITY POLYETHYLENE PIPE (HDPE) WITH A SMOOTH INTERIOR AND ANNUAL EXTERIOR CORRUGATIONS IN ACCORDANCE WITH ASTM F-2948. JOINTS SHALL BE WATER-TIGHT IN ACCORDANCE WITH ASTM D-3012.
- ELECTRIC, TELEPHONE, FIRE ALARM AND CABLE TELEVISION LINES SHALL BE INSTALLED UNDERGROUND IN CONDUIT IN ACCORDANCE WITH THE REQUIREMENTS OF THE UTILITY COMPANY HAVING JURISDICTION.

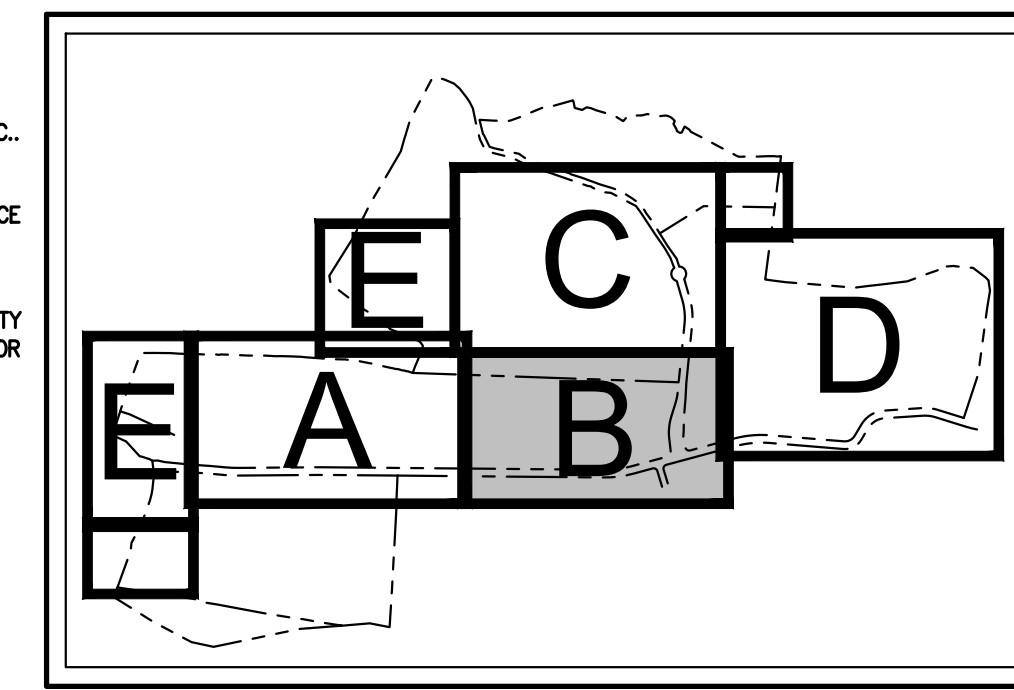

KEY MAP
SCALE: 1" = 1,500'

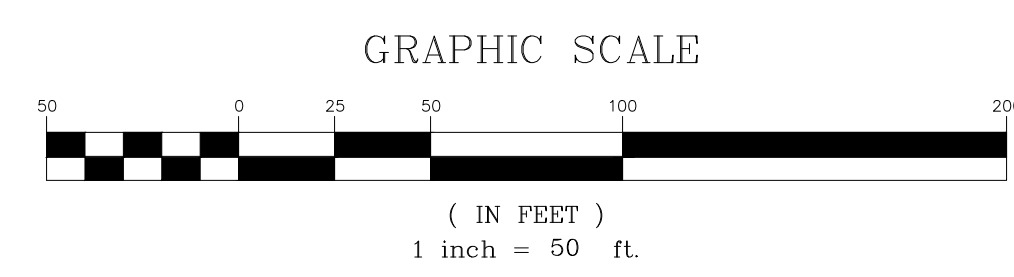

LEGEND

(Symbol)	EXISTING/PROPOSED PROPERTY LINE
(Symbol)	PROPOSED SUBDIVISION LINE
(Symbol)	ADJACENT PROPERTY LINE
(Symbol)	EXISTING METLAND LINE AND DELINEATION
(Symbol)	EXISTING INSECT METLAND BUFFER
(Symbol)	EXISTING TOWN METLAND BUFFER
(Symbol)	EXISTING BUILDING
(Symbol)	EXISTING PAVEMENT EDGE/CURB LINE
(Symbol)	EXISTING STONE WALL
(Symbol)	EXISTING GUIDE RAIL
(Symbol)	EXISTING FENCE
(Symbol)	EXISTING STORM DRAIN LINE AND SIZE
(Symbol)	EXISTING OVERHEAD WIRES
(Symbol)	EXISTING UTILITY POLE
(Symbol)	PROPOSED BUILDING LINE
(Symbol)	PROPOSED WATER STORAGE TANK LINE
(Symbol)	POTENTIAL FUTURE BUILDING BY COUNTY
(Symbol)	PROPOSED EDGE OF PAVEMENT/CURB LINE
(Symbol)	PROPOSED LANDBANKED PARKING
(Symbol)	PROPOSED CONCRETE SIDEWALK
(Symbol)	PROPOSED DROP CURB AND RAMP
(Symbol)	PROPOSED SANITARY SEWER MANHOLE
(Symbol)	PROPOSED STORM DRAIN MANHOLE
(Symbol)	PROPOSED TYPE CI DRAIN INLET
(Symbol)	PROPOSED TYPE DI DRAIN INLET
(Symbol)	PROPOSED RIP-RAP APRON
(Symbol)	PROPOSED HEADWALL
(Symbol)	PROPOSED END SECTION
(Symbol)	PROPOSED HYDRANT
(Symbol)	PROPOSED STORM DRAIN LINE & SIZE
(Symbol)	PROPOSED SANITARY SEWER LINE & SIZE
(Symbol)	PROPOSED WATER LINE & SIZE
(Symbol)	PROPOSED CONCRETE ENCLOSURE
(Symbol)	PROPOSED WATER VALVE
(Symbol)	PROPOSED RETAINING WALL (DESIGN BY OTHERS)
(Symbol)	PROPOSED DOUBLE ARM LIGHTING STANDARD (DESIGN BY OTHERS)
(Symbol)	PROPOSED SINGLE ARM LIGHTING STANDARD (DESIGN BY OTHERS)
(Symbol)	PROPOSED UTILITY POLE
(Symbol)	BORING LOCATION AND DESIGNATION
(Symbol)	EXISTING FEATURE TO BE REMOVED

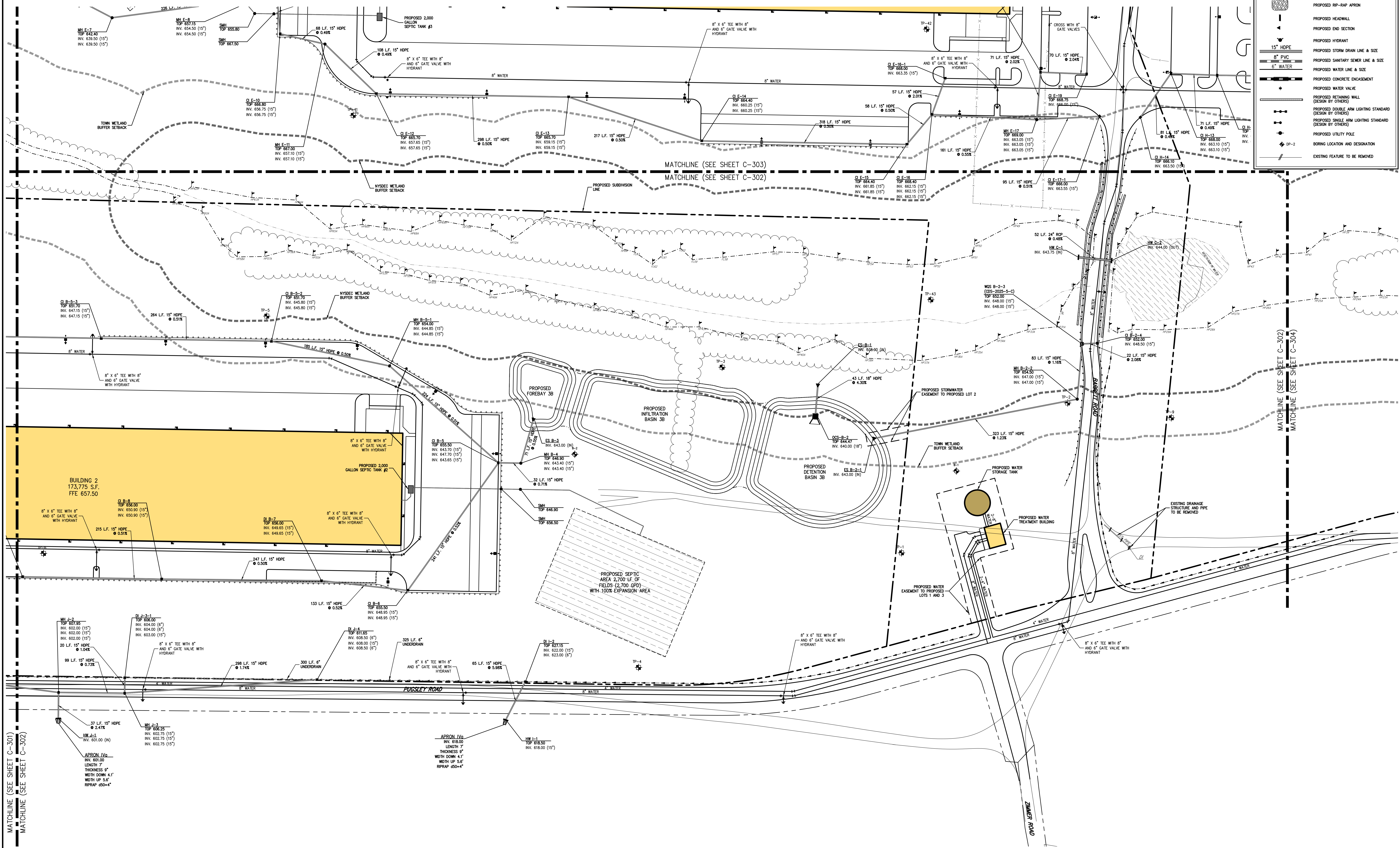

NOT FOR CONSTRUCTION

MATCHLINE (SEE SHEET C-301)
MATCHLINE (SEE SHEET C-302)

MATCHLINE (SEE SHEET C-302)
MATCHLINE (SEE SHEET C-304)

By: **KRM**
Date: **05/17/2018**

Revision: **1**
Description: **DESIGN COMPLETENESS SUBMISSION**

APP. CANTOWER: **PUTNAM SEABURY PARTNERS, L.P.**
287 KING STREET
CHAPPAQUA, NY 10514

JMC Planning, Engineering, Landscape Architecture & Land Surveying, LLC
John Mayer Consulting, Inc.
120 BEVERLY ROAD - HERRING, NY 13348
PHONE: 518-333-5535 - FAX: 518-333-2102
www.jmcpllc.com

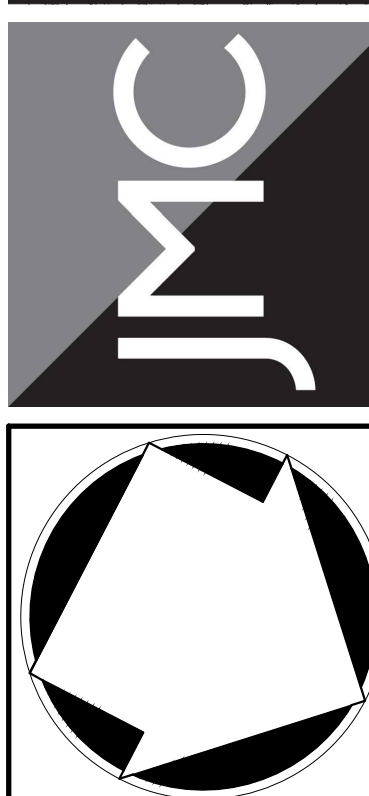

UTILITIES PLAN 'B'
NORTHEAST INTERSTATE LOGISTICS CENTER
TOWN OF SOUTHEAST, NEW YORK

ANY ALTERATION OF PLANS, SPECIFICATIONS, PLATS AND REPORTS BEARING THE SEAL OF A LICENSED PROFESSIONAL ENGINEER OR LICENSED LAND SURVEYOR IS A VIOLATION OF SECTION 7209 OF THE NEW YORK STATE EDUCATION LAW, EXCEPT AS PROVIDED FOR BY SECTION 7209, SUBSECTION 2.

Drawn: **KRM** Approved: **R.P.**
Scale: **1" = 50'**
Date: **11/06/2017**
Project No: **14012**
Sheet No: **UTL B** of **3**
Drawing No: **C-302**