

Calculation Summary								
Label	Units	Avg	Max	Min	Avg/Min	Max/Min	PtSpCr	PtSpCb
BUILDING 1	Fc	1.48	4.6	0.2	7.40	23.00	20	20
BUILDING 1 & 2 ENTRANCE	Fc	2.09	4.4	0.4	5.23	11.00		
BUILDING 2	Fc	1.46	4.7	0.3	4.87	15.67		
BUILDING 3	Fc	1.29	4.6	0.1	12.90	46.00		
BUILDING 4	Fc	1.48	4.3	0.2	7.40	21.50		

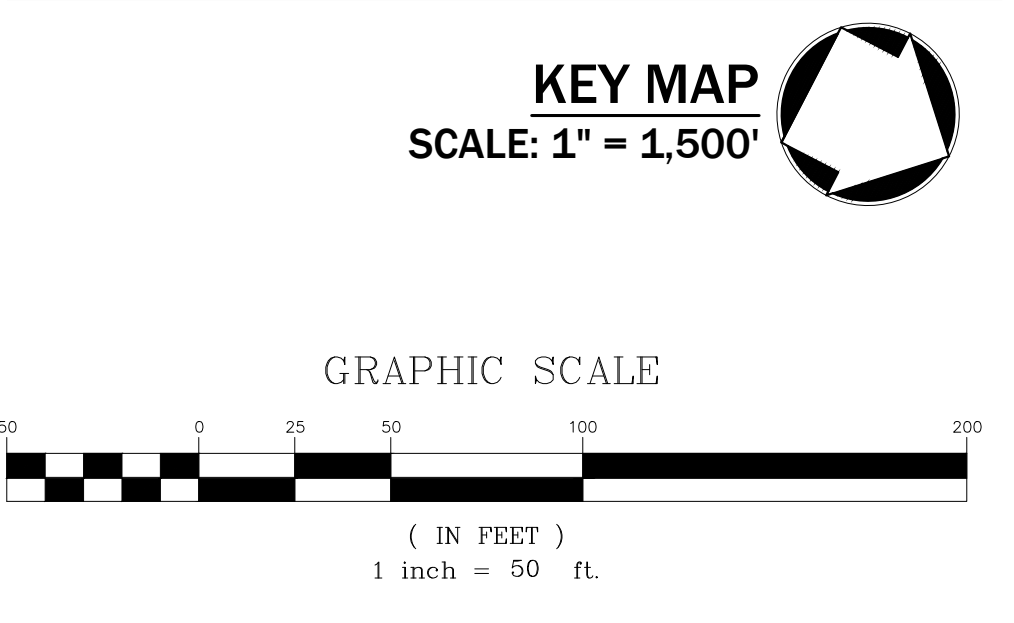

Luminaire Schedule							
Symbol	Qty	Label	Total Lamp Lumens	LLF	Description		Lum. Watts
	12	A	N.A.	0.950	WLS-MIR-5W-LED-HO-50 27' POLE 3' BASE		244
	53	B	N.A.	0.950	WLS-MIR-FT-LED-HO-50 27' POLE 3' BASE		241.3
	4	C	N.A.	0.950	WLS-MIR-2-LED-HO-50 27' POLE 3' BASE		241
	5	D	N.A.	0.950	WLS-MIR-FT-LED-HO-50-IL 27' POLE 3' BASE		241.3
	115	E	N.A.	0.950	WLS-MIRW-FT-LED-08-50 16' MOUNTING HEIGHT		76

NOTES:
 1. ALL CABLES AND WIRING SHALL BE INSTALLED UNDERGROUND IN CONDUIT. CONDUIT SHALL BE SCHEDULE 40 PVC CONDUIT INSTALLED WITH TWO (2) FEET OF COVER. MINIMUM SIZE OF CONDUIT SHALL BE TWO (2) INCH DIAMETER.

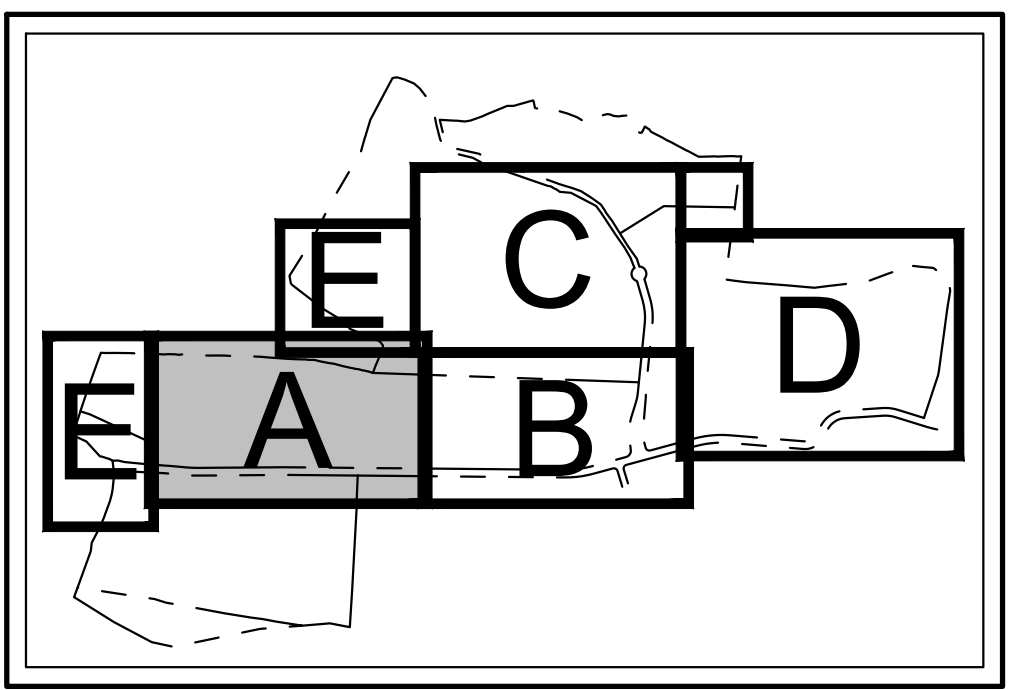
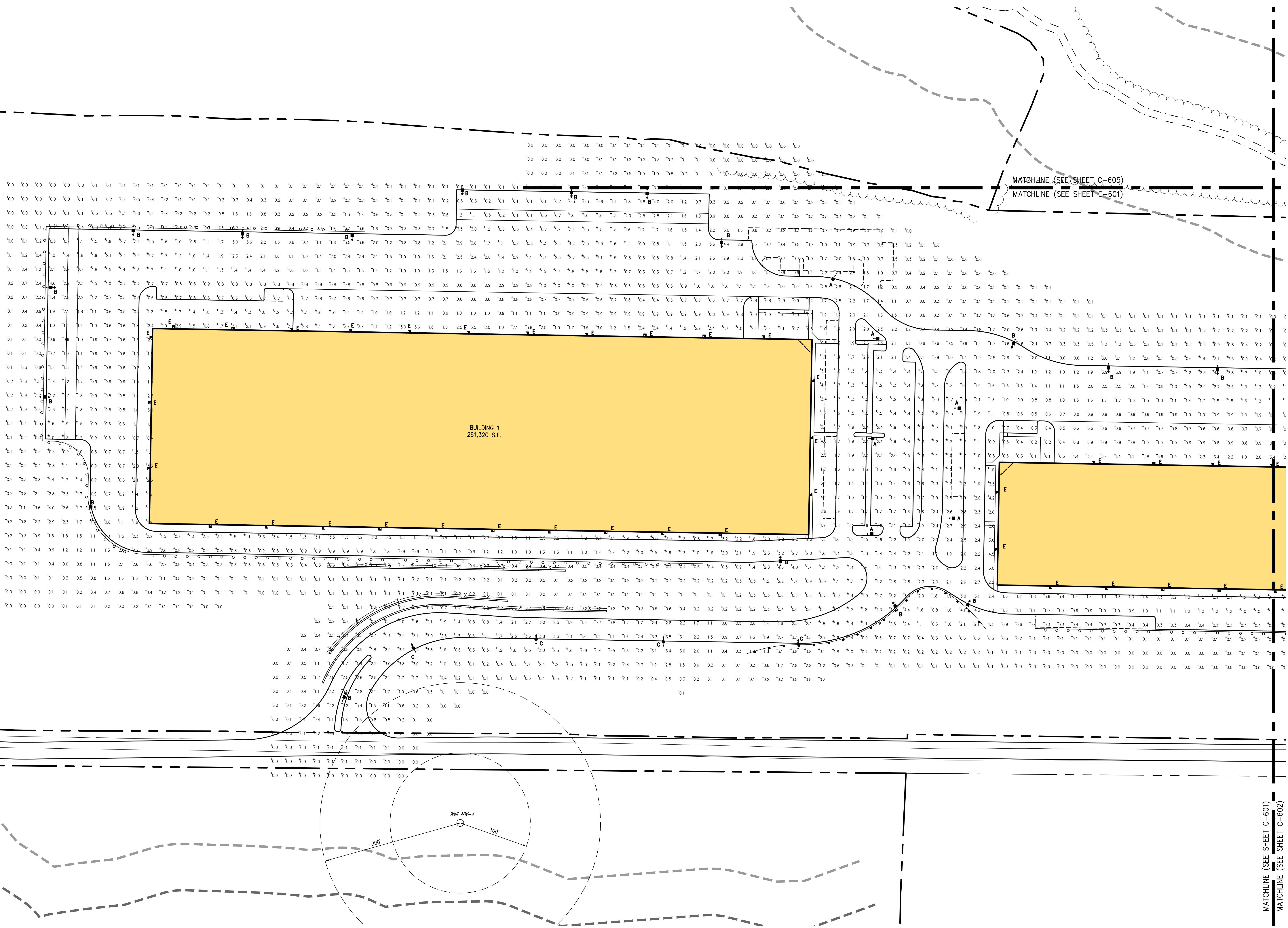

MATCHLINE (SEE SHEET C-605)
MATCHLINE (SEE SHEET C-601)

NOT FOR CONSTRUCTION

By: **KRM**
 Date: **05/17/2018**
 Reason: **REVISION**
 1. **REVISION**
 1. **REVISION**
 1. **REVISION**

PUTNAM SEABURY PARTNERS, L.P.
 287 KING STREET
 CHAPPAQUA, NY 10514

JMC
 JMC Planning, Engineering, Landscape Architecture & Land Surveying, LLC
 JMC Site Development Consultants, LLC
 John Meyer Consulting, Inc.
 123 BEVERLY ROAD - ARLINGHAM, NY 10504
 PHONE: 914.233.5255 FAX: 914.272.0102
 www.jmcplc.com

LIGHTING PLAN 'A'
 NORTHEAST INTERSTATE LOGISTICS CENTER
 TOWN OF SOUTHEAST, NEW YORK

ANY ALTERATION OF PLANS, SPECIFICATIONS, PLATS AND REPORTS BEARING THE SEAL OF A LICENSED PROFESSIONAL ENGINEER OR LICENSED LAND SURVEYOR IS A VIOLATION OF SECTION 7209 OF THE NEW YORK STATE EDUCATION LAW, EXCEPT AS PROVIDED FOR BY SECTION 7209. SUBSECTION 2.

Date: **KRM** Approved: **R.P.**
 Scale: **1" = 50'**
 Date: **11/06/2017**
 Project No: **14012**
 NO. OF SHEETS: **14** LIGHTING PLAN 'A' LIGHTING PLAN 'A'
 Drawing No: **C-601**