

NOT FOR CONSTRUCTION

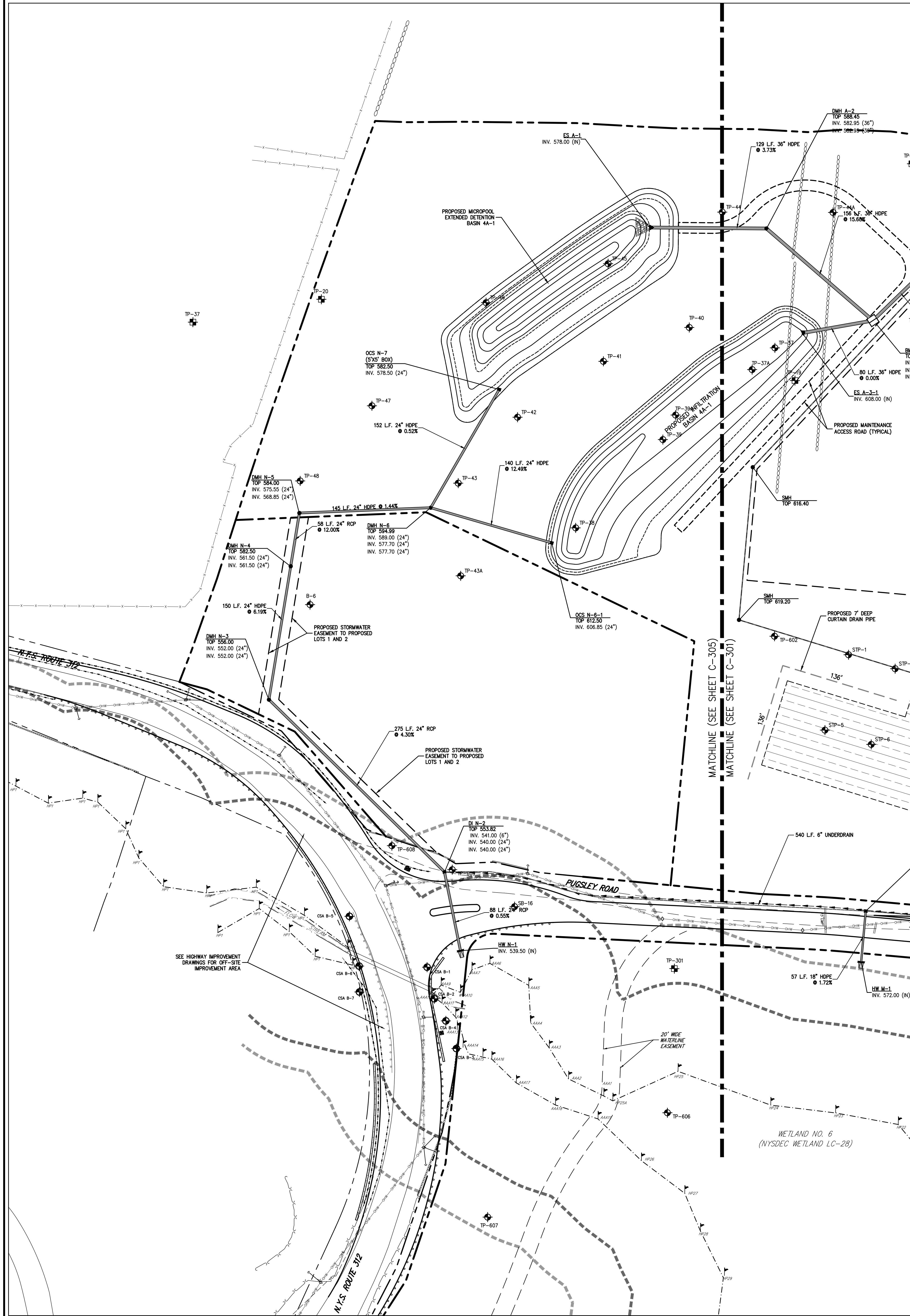

**LEGEND**

	EXISTING/PROPOSED PROPERTY LINE
	PROPOSED SUBDIVISION LINE
	ADJACENT PROPERTY LINE
	EXISTING WETLAND LINE AND DELINEATION
	EXISTING NYSDEC WETLAND BUFFER
	EXISTING TOWN WETLAND BUFFER
	EXISTING BUILDING LINE
	EXISTING PAVEMENT EDGE/CURB LINE
	EXISTING STONE WALL
	EXISTING GUIDE RAIL
	EXISTING FENCE
	EXISTING STORM DRAIN LINE AND SIZE
	EXISTING OVERHEAD WIRES
	EXISTING UTILITY POLE
	PROPOSED BUILDING LINE
	PROPOSED WATER STORAGE TANK LINE
	PROPOSED EDGE OF PAVEMENT/CURB LINE
	PROPOSED LANDSCAPED PARKING
	PROPOSED CONCRETE SIDEWALK
	PROPOSED DROP CURB AND RAMP
	PROPOSED SANITARY SEWER MANHOLE
	PROPOSED STORM DRAIN MANHOLE
	PROPOSED TYPE C DRAIN INLET
	PROPOSED TYPE D DRAIN INLET
	PROPOSED RIP-RAP APRON
	PROPOSED HEADWALL
	PROPOSED END SECTION
	PROPOSED HYDRANT
	PROPOSED STORM DRAIN LINE & SIZE
	PROPOSED SANITARY SEWER LINE & SIZE
	PROPOSED WATER LINE & SIZE
	PROPOSED CONCRETE ENCASUREMENT
	PROPOSED RETAINING WALL
	PROPOSED DOUBLE ARM LIGHTING STANDARD (DESIGN BY OTHERS)
	PROPOSED SINGLE ARM LIGHTING STANDARD (DESIGN BY OTHERS)
	PROPOSED UTILITY POLE
	BORING LOCATION AND DESIGNATION
	EXISTING FEATURE TO BE REMOVED

- NOTES:**
- EXISTING CONDITIONS DEPICTED ON THIS PLAN HAVE BEEN TAKEN FROM SURVEYS PREPARED BY BAKER & MITCHELL SURVEYING AND ENGINEERING, P.C.
  - GEOLOGICAL BORING/TEST PIT LOCATIONS DEPICTED ON THIS PLAN WERE TAKEN FROM THE GEOLOGICAL REPORT ENTITLED, "PRELIMINARY SUBSURFACE INVESTIGATION", DATED 10/07/1997, PREPARED BY SES CONSULTING ENGINEERS.
  - PAVEMENT CORE, STORMWATER TEST, SANITARY TEST LOCATIONS DEPICTED ON THIS PLAN WERE TAKEN FROM THE GEOLOGICAL REPORT ENTITLED, "GEOLOGICAL INVESTIGATION REPORT FOR PROPOSED NORTHWEST INTERSTATE LOGISTICS CENTER ROUTE 312 AND PUSLEY ROAD," DATED 06/12/2016, REVISED 11/07/2016, PREPARED BY SES CONSULTING ENGINEERS.
  - PIPE FOR STORM DRAINS IDENTIFIED AS HOPE HEREON SHALL BE HIGH DENSITY POLYETHYLENE PIPE (HDPE) WITH A SMOOTH INTERIOR AND ANNUULAR EXTERIOR CORRUGATIONS IN ACCORDANCE WITH ASTM F-2924E. JOINTS SHALL BE WATER TIGHT IN ACCORDANCE WITH ASTM D-3212.
  - ELECTRIC, TELEPHONE, FIRE ALARM AND CABLE TELEVISION LINES SHALL BE INSTALLED UNDERGROUND IN CONCORDANCE WITH THE REQUIREMENTS OF THE UTILITY COMPANY HAVING JURISDICTION.

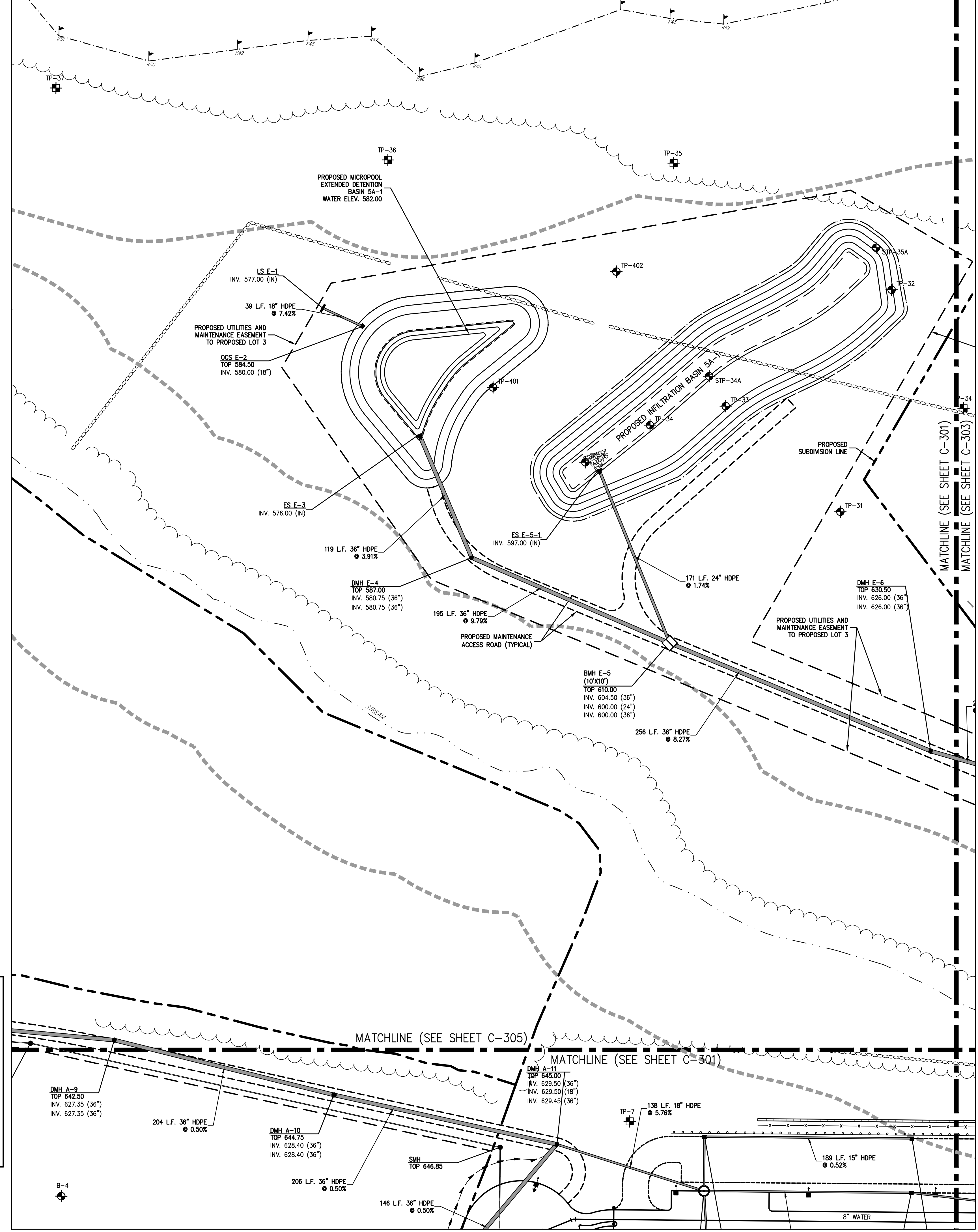
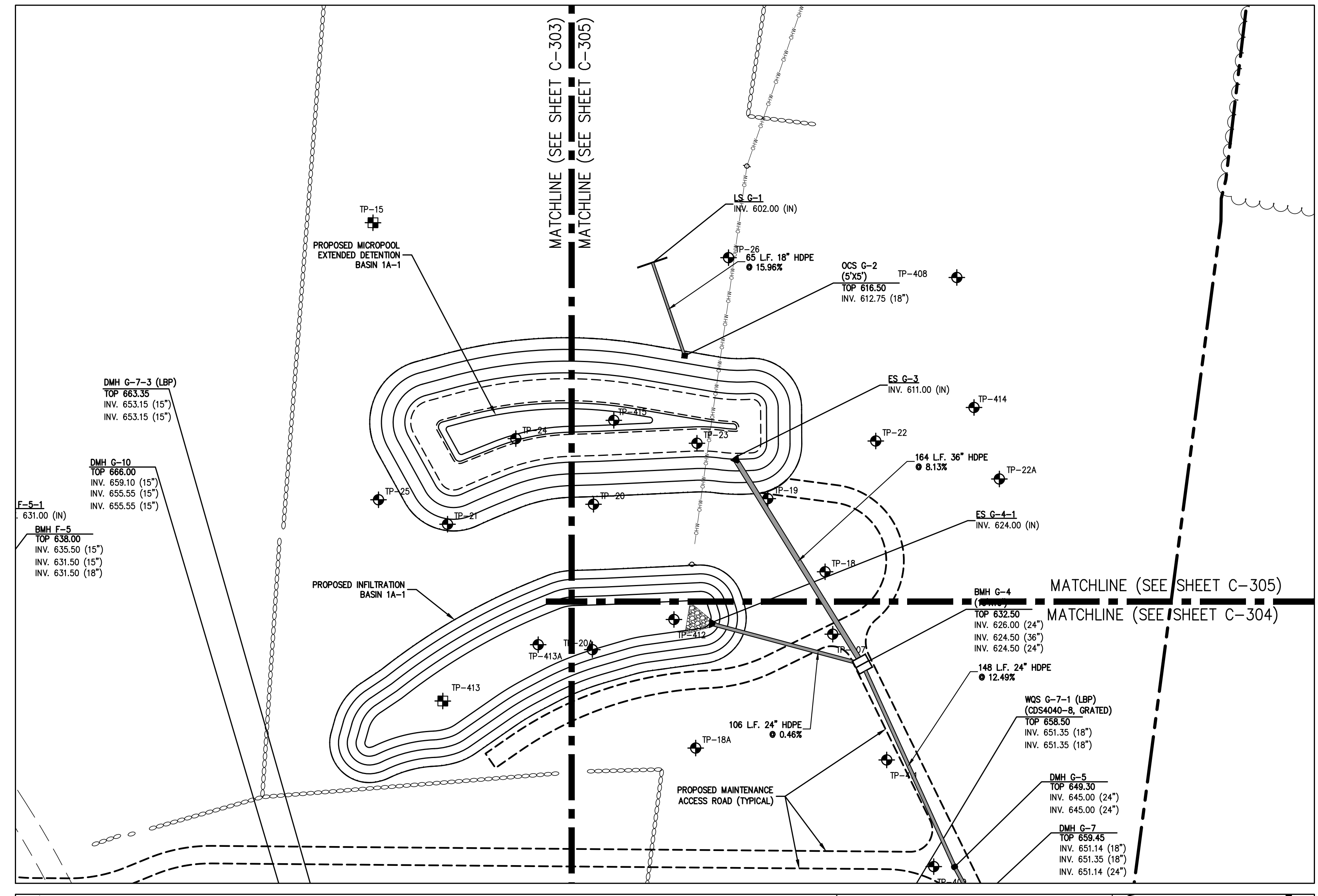
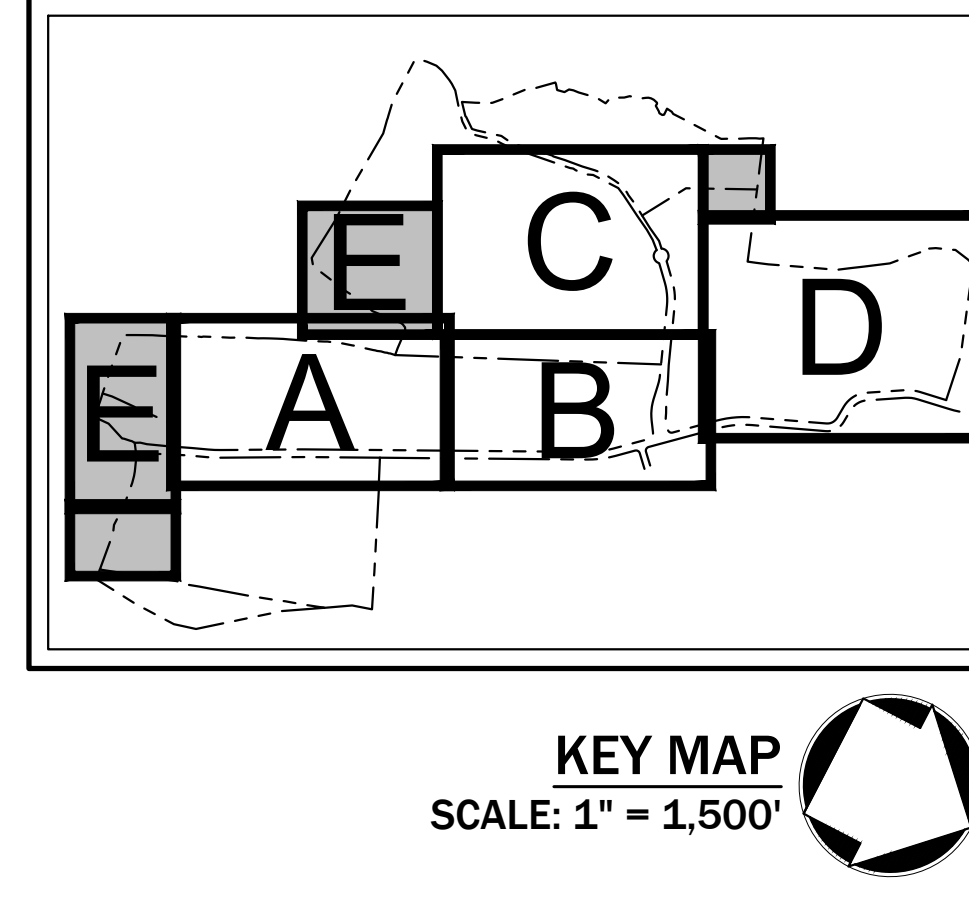
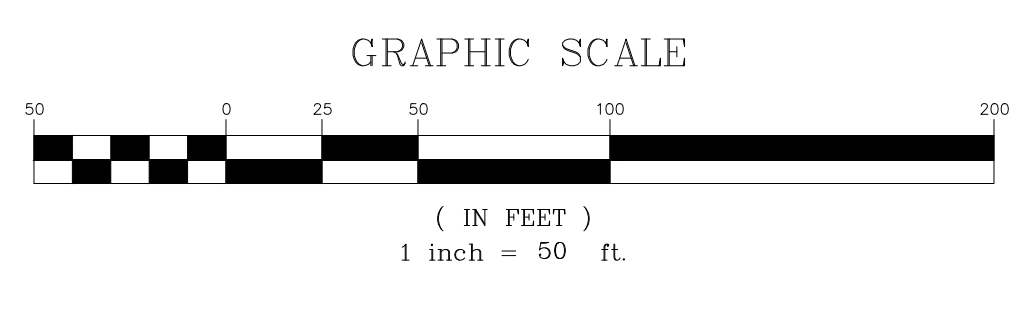

<p><b>APPLICANT/OWNER:</b></p> <p><b>PUTNAM SEABURY PARTNERS, L.P.</b> 287 KING STREET CHAPPAQUA, NY 10514</p>	<p><b>DATE:</b></p> <p>05/17/2018 05/18/2018</p>	<p><b>REVISION:</b></p> <p>1. THIS COMPLETENESS SUBMISSION 2. THIS COMPLETENESS SUBMISSION</p>	<p><b>BY:</b></p> <p>KRM KRM</p>
<p><b>JMC</b></p> <p>JMC Planning, Engineering, Landscape Architecture &amp; Land Surveying, LLC JMC Site Development Consultants, LLC John Meyer Consulting, Inc.</p> <p>120 BEAUFORT ROAD - ARMONK, NY 10504 VOICE 914.233.5253 - FAX 914.273.2192 WWW.JMCPINC.COM</p>			
<p><b>UTILITIES PLAN 'E'</b></p> <p>COMMERCIAL CAMPUS AT FIELDS CORNER TOWN OF SOUTHEAST, NEW YORK</p>			
<p>ANY ALTERATION OF PLANS, SPECIFICATIONS, PLATS AND REPORTS BEARING THE SEAL OF A LICENSED PROFESSIONAL ENGINEER OR LICENSED LAND SURVEYOR IS A VIOLATION OF SECTION 7209 OF THE NEW YORK STATE EDUCATION LAW, EXCEPT AS PROVIDED FOR BY SECTION 7209, SUBSECTION 2.</p>			
<p>Drawn: KRM</p> <p>Date: 11/06/2017</p> <p>Project No: 14012</p> <p>Scale: 1" = 50'</p>	<p>Approved: R.P.</p> <p>Date: 11/06/2017</p> <p>Project No: 14012</p> <p>Scale: 1" = 50'</p>	<p><b>C-305</b></p>	